

# Q3 - EXTENSION TO LIVING SPACE

ADD ADDITIONAL LIVING SPACE. MAKE BEST USE OF LIGHT AND MAKE OPEN PLAN

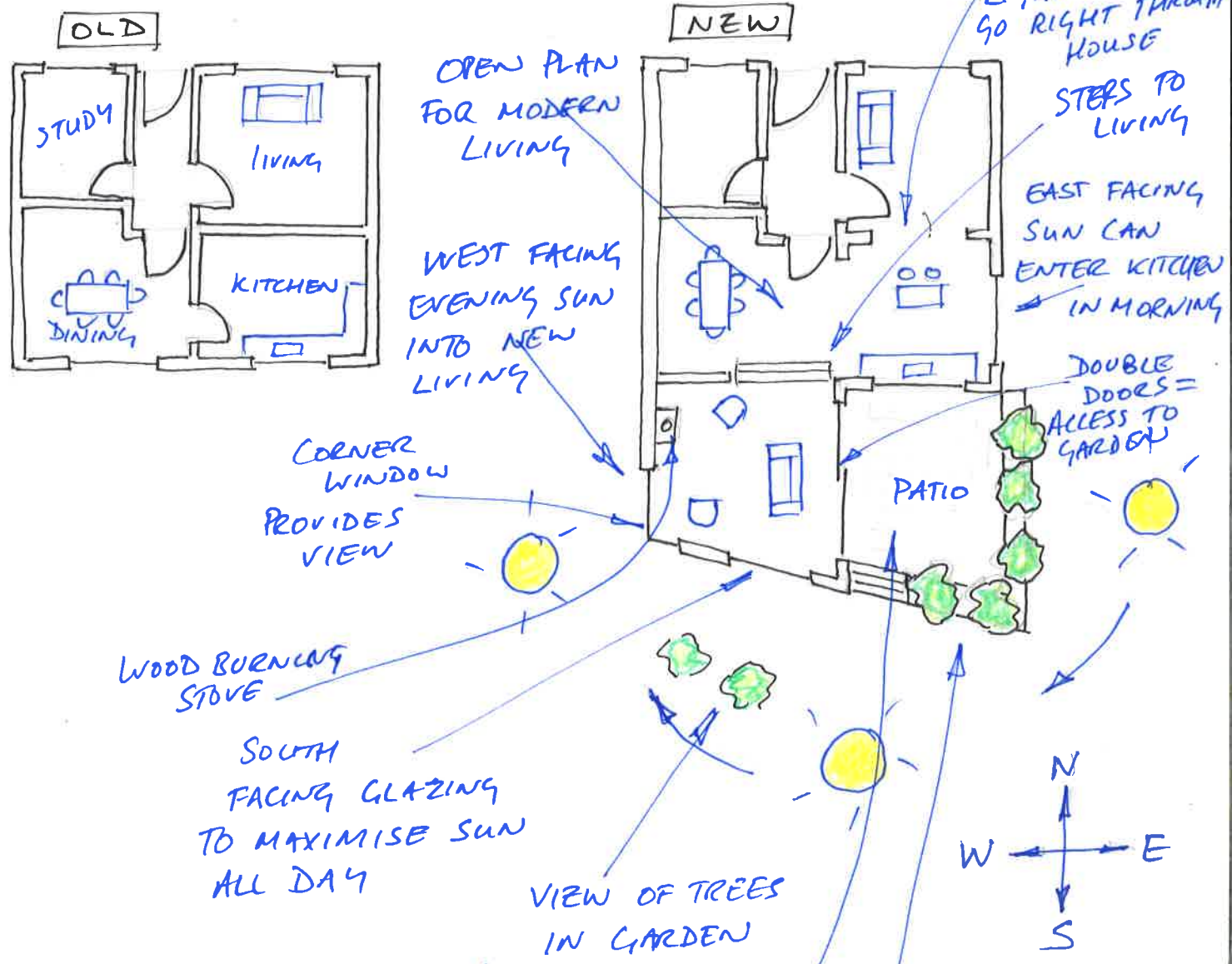

- WALLS REMOVED CREATES OPEN PLAN LIVING / DINING / KITCHEN
- SLIDING DOOR PROVIDES EASY ACCESS TO GARDEN HOUSE LINKED TO NATURE
- PLANTING TO REAR PROVIDED VIEW

PATIO CREATES LINK WITH GARDEN  
 PATIO PAVED  
 PLANTING AROUND PATIO

- SKY LIGHT PROVIDES LOTS OF NATURAL LIGHT AND HEAT TO LIVING SPACE
- LARGE AMOUNT OF SOUTH FACING WINDOWS. - LIGHT/HEAT
- LINK WITH NATURE HELPS WELLBEING. ENJOYABLE PLACE TO LIVE, RELAXING. 90% OF OUR TIME IS SPENT INDOORS.

EXTERNAL VIEW

